

SIGNATURE

NORTH EAST

OFFICIALLY RATED THE NO.1 ESTATE AGENT IN THE NORTH EAST





 Huntingdon Place, North Shields NE30 4RF

Huntingdon Place, North Shields NE30 4RF

Offers Over £360,000

Signature North East is delighted to welcome to the market this charming 2-bedroom maisonette, situated in the heart of Tynemouth. This Grade 2 listed building is in a highly desirable location, ideal for families due to the excellent schools nearby, including the well-regarded Kings Priory School. The property benefits from brilliant transport links, with Tynemouth Metro Station just a short walk away. Local amenities are conveniently close, with Tynemouth Town Centre, Tynemouth Priory and Castle, and the beautiful beach all within easy reach.

Upon entering, you are welcomed into a central hallway leading to a spacious open-plan kitchen and dining area, perfect for entertaining and relaxation. This large, bright room can easily accommodate a dining table and is adjacent to a cosy living room, which features ample space for desired furnishings and a large window that fills the room with natural light. The living room also provides access to the rear yard area, seamlessly blending indoor and outdoor living spaces. The kitchen offers ample storage with attractive wall and base units, complemented by sleek countertops. A convenient W.C. is located next to the kitchen/dining room, and the entire property boasts new carpets throughout.

The first floor comprises two generously sized bedrooms, both of which can comfortably accommodate a double bed and additional furnishings. Bedroom one stands out with its recent renovations, a beautiful fireplace and two large windows that flood the room with natural light. The first floor is completed by a well-appointed bathroom featuring a bathtub, walk-in shower, hand basin, and W.C.

Externally, this home offers a serene, private yard area, perfect for outdoor furniture. The yard provides access to the school playground, where residents are permitted to park two cars during certain hours and school holidays, directly behind the property. Additionally, there is residential and visitor parking on the street, requiring a permit.

This property holds significant potential, whether as a comfortable home or an investment opportunity, such as an Airbnb.



PLEASE NOTE THAT THE VENDOR HAS CERTIFIED THE PROPERTY INFORMATION AND IMAGES.

PROPERTY FLOORPLAN

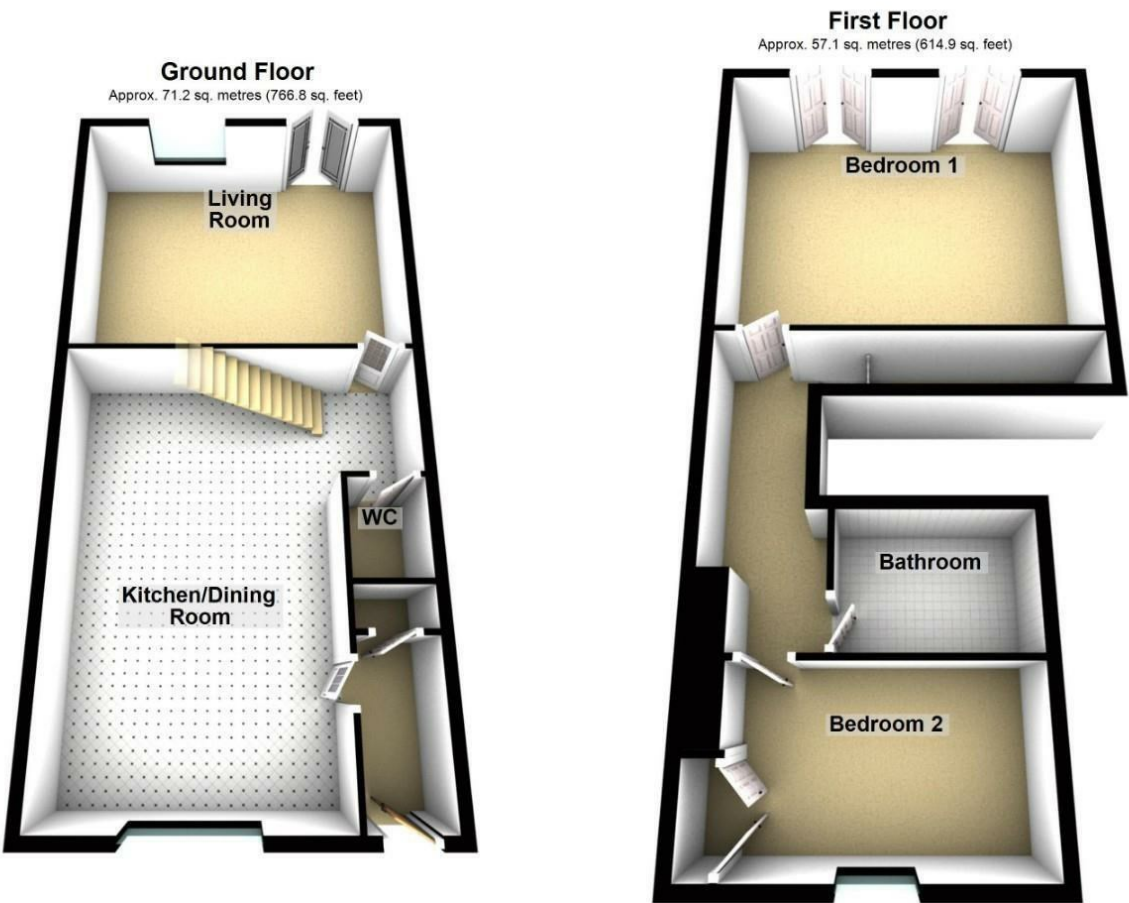

Total area: approx. 128.4 sq. metres (1381.7 sq. feet)

Please be advised the floorplans are not drawn to scale and are to be used to give an idea of the layout of the property.
Plan produced using PlanUp.

Measurements:

- Living Room
19'1" x 15'8"
- Kitchen / Dining Room
24'0" x 19'1"
- WC
5'2" x 4'4"
- Bedroom One
19'1" x 15'9"
- Bedroom Two
13'2" x 8'3"
- Bathroom
8'11" x 6'3"

Energy Efficiency Rating		
	Current	Potential
Very energy efficient - lower running costs		
(92 plus) A		87
(81-91) B		
(69-80) C	77	
(55-68) D		
(39-54) E		
(21-38) F		
(1-20) G		
Not energy efficient - higher running costs		
England & Wales		EU Directive 2002/91/EC





More 5 Star Customer Reviews than any other Agent based in the North East on allAgents.co.uk



SALES

LETTINGS

FINANCE

LAW

WE COVER THE WHOLE OF THE NORTH EAST

Whitley Bay
0191 251 3344

Cramlington
01670 897 213

Tynemouth
0191 296 6689

Morpeth
01670 513 966

Ponteland
01661 820 082

Wallsend
0191 432 4151

Alnwick
01665 511 800

Heaton
0191 432 4275

Forest Hall
0191 266 9966

Other locations
0191 640 3523

Newcastle
0191 640 2284

Durham
0191 303 8252

Gosforth
0191 640 3523

Sunderland
0191 543 6390

Whickham
0191 432 5102

Gateshead
0191 432 4294

Jesmond
0191 281 1037

Killingworth
0191 640 3602

Ryton
0191 413 9845

Head Office &
Lettings
0191 253 4815

*Highest recommended 5-star reviews than any other Estate Agent based in the North East on allAgents.co.uk - The UK's Largest Customer Review Website for the Property Industry & Awarded Best Estate Agency 2018 & 2019 - North East England by SME News